

M-Tel AUTO CONTROL

Fast and efficient vehicle tracking
from your phone or PC
> Plug & Play GPS Device
> 24/7 Call Center

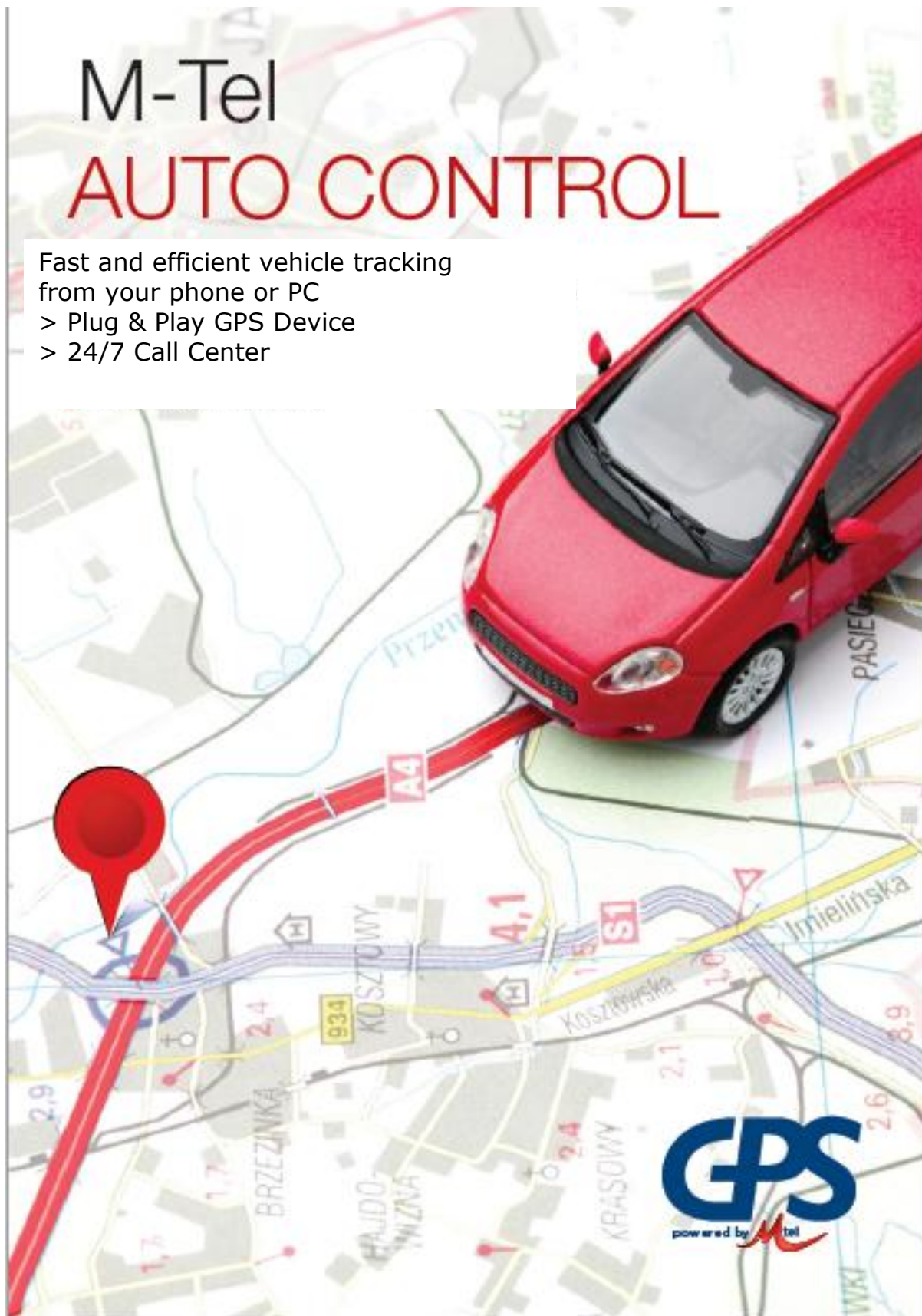

GPS
powered by **M-tel**

Device installation manual

The vehicle tracker M-Tel AUTO CONTROL consists of several components:

- 1 - main device with GPS receiver
- 2 - SIM card and car charger (plugged in the lighter socket of the vehicle)
- 3 - cable connecting the GPS receiver and the charger.



Connect the main device to the charger and attach it to the vehicle. Make sure that the side marked "This side up" is indeed at the upper side. For best reception of the GPS signal choose one of the following places:

- > on the windshield
- > in the lower part of the rear shield
- > above the rear-view mirror
- > on the dashboard

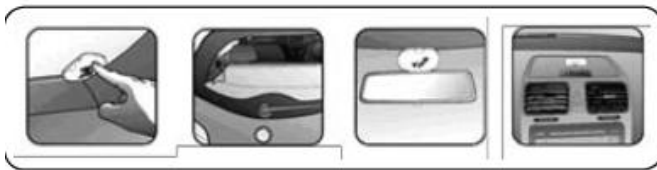

When selecting the place, take into account that the device:

- > should be positioned on a dry and stable base
- > should not be exposed to excessive temperature
- > should be protected from strong vibrations
- > should not be shielded from the GPS signal (the GPS signal indicator must flash intermittently), i.e. there must not be any metal surfaces above
- > should not be close to the electronic systems of the vehicle
- > should be easily accessible from any point in the vehicle.



LED 1 - GPS positioning indicator	Flashes intermittently when the device is ON - GPS positioning is enabled
	Does not flash - GPS positioning is disabled
LED 2 - GPS network connection indicator	Does not flash - the device is not connected to M-Tel's GSM network
	Flashes intermittently - the device is connected to M-Tel's network, but there is no connection to the server of the M-Tel AUTO CONTROL service
	Permanently ON - the device is connected both to M-Tel's network and to the service server
LED 3 – Power supply status indicator (power supply mode)	Permanently ON - the device is connected to the vehicle's power supply system
	Permanently OFF – power supply from the vehicle is disconnected

Service registration requirements

The M-Tel AUTO CONTROL service requires registration at www.gps.bg/fm/register. You need to register a new user account before starting to use M-Tel AUTO CONTROL. As part of the registration process, you should provide details of the relevant natural or legal person, the serial number of the device and an IMEI code. Once you complete the registration of the user account, you will receive an automatic e-mail to activate your access to the service. You may add more mobile devices to an existing account at www.gps.bg/fm.



Should you have any questions about the registration or the subsequent usage of the service, please contact the GPS customer care centre at 0888 48 00 47 and 088 110 86 30 or drop us an email at customercare@gps.bg.



How to use the service

Once your registration is successfully completed, you can use the vehicle tracking application at www.gps.bg/fm.

M-Tel AUTO CONTROL enables you to position vehicle-mounted devices on geographic maps, which form part of tracking applications. The service can be used with an Internet-enabled computer and/or telephone. You need to have at least one M-Tel AUTO CONTROL device, a standard Internet browser (Mozilla Firefox, Internet Explorer, Safari or Chrome) and a valid e-mail address.

How to use M-Tel Auto Control from mobile phone

- > Before to log in the application you have to previously enter the GSM number which you intend to use for the Service (for example 359887123456) on URL: www.gps.bg/fm/ (accessible from computer), Tab „Configuration” > Subtab „User”> field „Mobile phone” (look at Tab „Configuration”, page 23).
- > After that you will have access to the service trough mobile phone.
- > Get started from: <http://m.gps.bg>



The application enables for:

- > Vehicle positioning through field „Search acc. to“– Registration plate, Code number or Driver’s name;
- > Refreshing of the position;
- > Sending of the position through MMS.

Using of the application will generate GPRS traffic on your SIM card. The charging of this traffic is according to your current price plan. We recommend subscription for Vodafone Live or data package (min 100 MB).

What can the M-Tel AUTO CONTROL service do for you

- > Check the last registered position of the vehicle.
- > Track the movement of the vehicle in real time with the engine on.
- > Track the vehicle’s speed and movement direction.
- > Check the vehicle’s route/itinerary and mileage during previous periods.
- > Option to add sites and areas in order to control the visits to these sites and areas.
- > Define mandatory routes/itineraries and diversion alarms
- > Define alarm notifications (of events such as exceeded speed limit).
- > Control the various levels of access to the system.

Additional options

The following additional options are available:

- > Concealed installation of the GPS device and connection to a permanent power source;
- > Fuel control or SOS button.

With the additional option Concealed installation, the system allows you to track the downtime of the vehicle and generate a variety of automatic reports:

- > Itinerary report
- > Report for vehicle usage
- > Vehicle overnight stops outside the designated areas
- > Vehicle used outside the working hours
- > Vehicle downtimes in excess of the authorized time-limits.

It is good to know

Any attempt to install the device in a way different from the instructions in this Manual or outside the authorised service centres of GPS Bulgaria invalidates the device guarantee.

- > The options Fuel control and SOS button require Concealed installation of the GPS device.
These services require additional payment at the service centres of GPS Bulgaria.
- > The installation of the Fuel control option is subject to the following preconditions: the level gauges of the vehicle must be in good working order, the fuel tanks must not be interconnected and the subscriber must provide details for at least 3 (three) full charges with fuel of each motor vehicle.

- > The SIM card that comes with the device is intended for use with the device exclusively. Any usage with a telephone or computer will attract the standard tariffs of M-Tel.

Contact us

Should you wish to use any of the additional options for this service, please contact the Service Centre of GPS Bulgaria in Sofia at 088 110 8721 or drop them an email at gps-service@gps.bg.

Updates and detailed instructions for using the service are available at www.gps.bg/fm.